

**SECTION B-B**

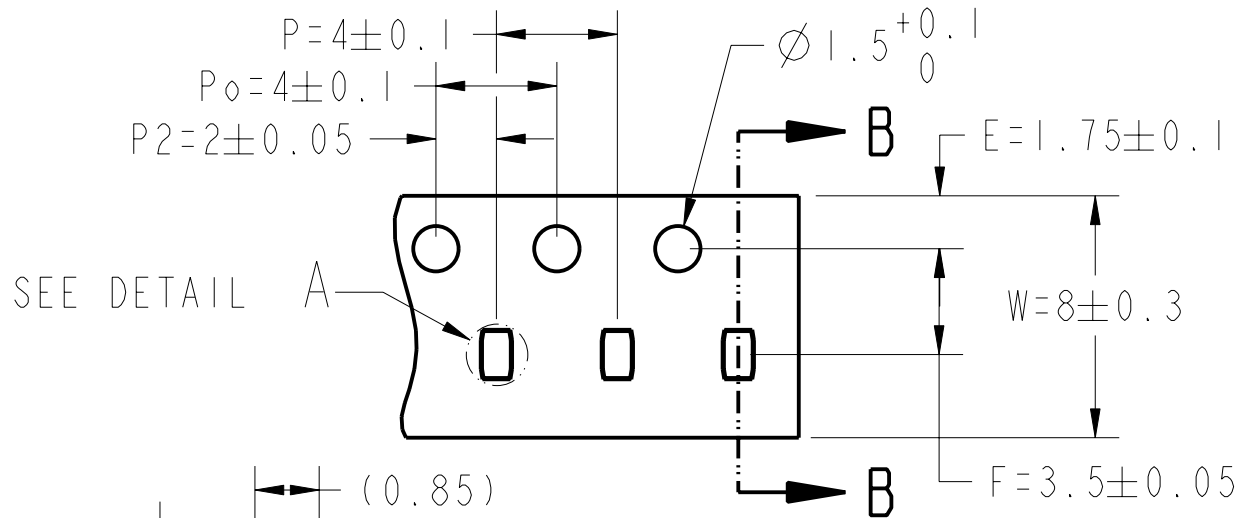

SEE DETAIL A

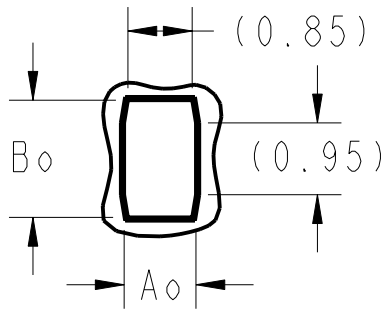

**DETAIL A**

SCALE 10.000

NOTES:

1. EIA-481 STANDARDS APPLY
2. POCKET POSITION RELATIVE TO SPROCKET HOLE MEASURED AS TRUE POSITION OF POCKET, NOT POCKET HOLE
3.  $P_{10} = P_0 \times 10$

4. NUMBER IDENTIFIES PRODUCT CONFIGURATION. FOR COMPLETE ORDER NUMBER TO INCLUDE MATERIAL TYPE AND QUANTITY PER REEL, CONTACT CUSTOMER SERVICE.

$A_0$	$0.95 \pm 0.03$ [0.037 ± .001]
$B_0$	$1.55 \pm 0.03$ [0.061 ± .001]
$K_0$	$0.50 \pm 0.05$ [0.020 ± .002]

<b>IMPORTANT NOTICE:</b>				<b>A</b> SIZE
DRAWING DOES NOT CONTAIN ALL DIMENSIONS, SPECIFICATIONS, AND TOLERANCES. THIS DRAWING IS INTENDED TO ASSIST THE CUSTOMER IN DESIGNING AN INTERFACE MODULE BETWEEN THE CUSTOMER'S EQUIPMENT AND <b>Accutech</b> PRODUCT/EQUIPMENT. ALL DIMENSIONS AND TOLERANCES IF DEFINED ARE PER ASME Y14.5M - 1994				THIRD ANGLE PROJECTION
NOTE: ALL DIMENSIONS ARE CONSIDERED CRITICAL.			DESCRIPTION	X-13568
			TAPE - MOLDING 0603 8mm	
			PART NO. CT00474	
			MATERIAL SEE NOTE	
ALL DIMENSIONS ARE IN MILLIMETERS [INCHES]	DRAWN BY K. ANDERSON	DATE 20-Jul-05	DRAWING NO. 01-033149	ECO NO. REV.
DO NOT SCALE	SHEET 1 OF 1			<b>A</b>